



# Passing Comment

## Anglia Estate Art Project News

Open Space area between Hartest, Minsmere, Raydon & Rede Way



Artist Les Bicknell has been working in schools, visiting residents and holding open day activities at Clover Court to generate ideas from you for the circular artworks which will be placed along the pathways at the open space.

Les will be taking all the ideas, thoughts and information he has gathered from working with you to create a complete design for the artworks.

**Next month you will receive the designs through the post.**

Inside this newsletter:

- Les tells you what has been happening so far.
- Peter, the estate ranger and Zoe give their thoughts on the "Passing Comment" project and their involvement.

From Les and all the team, thank you for all your involvement so far!

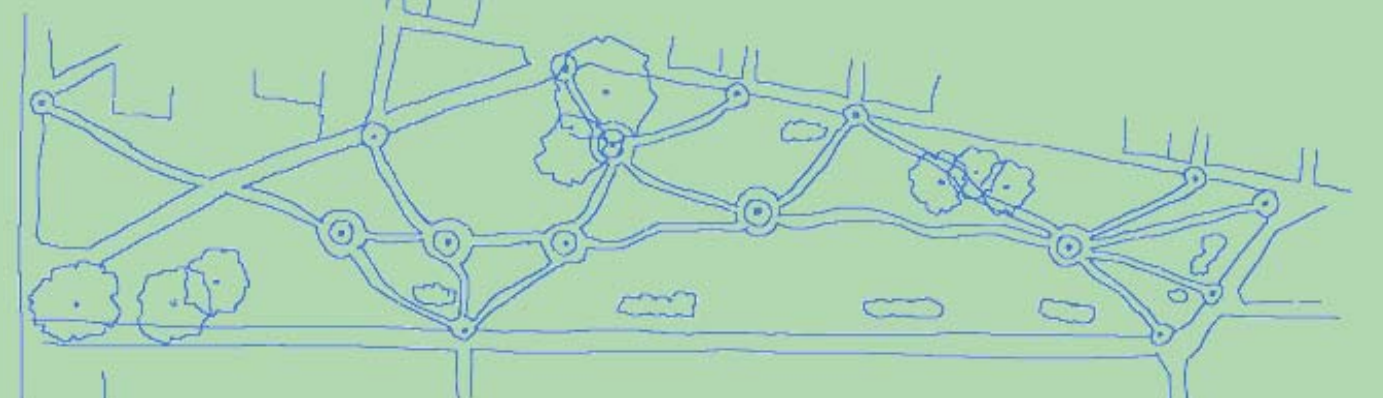

## Passing Comment DIARY EVENTS NEWS

**Residents will receive the artwork designs in July.**

**Work is due to begin on site at the beginning of September and end beginning of November 2006.**

**Want more information?**

### Contact

**Peter Swinney,**  
Estate Ranger  
**01787 881738** (answer phone)

**Susie Tyrrell,**  
Arts and Community  
Development Officer  
**01473 826615.**

'For me this project is about people and the area they live in.'

The involvement of the residents and children has been very positive. By working together they can create something as a group that they can all enjoy and feel proud of.'



**Peter Swinney**  
Estate Ranger

"Having the opportunity to work alongside Les Bicknell and all the groups and individuals in Great Cornard has given me a greater understanding of the community and its spirit.

I have met some wonderful characters, both children and adults. The children have the great potential to look forward into the future and have a great understanding of the bigger world. The conversations I have had with older generation about how they came to live in Great Cornard has been fascinating.

I would like to thank those that I have met and for sharing their experiences with me, Les and the project."

**Zoe Martin**  
Student



[www.babergh.gov.uk](http://www.babergh.gov.uk)

Click on leisure, tourism, & culture, then Culture and Anglia Estate Arts Project





**Over** the months of April and May I have worked and presented to over 1,000 people in Great Cornard. This activity has taken place in living rooms, assembly halls, classrooms, a drop-in centre and outside.

I have run enthusiastic informative assemblies with pupils from Pot Kiln, Wells Hall Primary and Great Cornard Middle Schools, while a virtual version of me has held forth at a week of assemblies at Great Cornard Upper School.

The title **“Passing Comment”** has led to asking the question **what is important?**

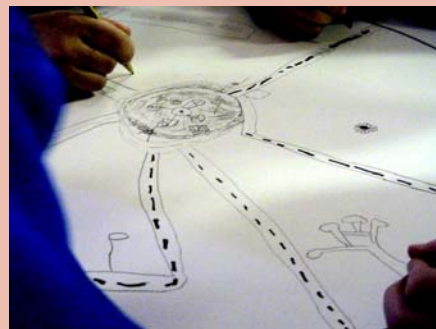

Now, I was led to believe that all young people cared about was X Box and watching TV, but the overwhelming response to the question **what is important?** has reinforced my belief in human nature because inspiring, **FAMILY AND FRIENDS** have featured heavily, acknowledging that human contact and support which comes from **FAMILY AND FRIENDS** is valued.

### ‘Inspiringly Family and Friends have featured heavily’

I have been meeting with some of the older residents of Great Cornard and listening to their memories and thoughts.

They have provided an insight into the experience of being a resident when the houses were very first built.

The history of Great Cornard is fascinating and closely tied up with the experience of this country in general, post war.

I have also been involved in bringing students from Great Cornard Middle and Upper School together to develop a number of art pieces. It was important for me to attempt to give students an insight into my role as an artist working in Great Cornard.

After a visit to the estate, the students worked in groups to develop their own ideas for the space, creating dramatic designs that included ponds, bins, benches and flower beds. These designs were affected and dramatically changed when the thoughts, needs and desires of the residents were introduced.

This led to more fascinating discussion and adds to developing understanding.



‘It would be possible to have the ideas and thoughts of an 8 year old and an 80 year old within the same design circle ‘talking’ to each other ...



**I could not do this work without the many individuals and groups who have welcomed and supported me, thank you again.**

I have worked with Peter, the estate ranger and fellow artist Zoe at Open Workshops at Clover Court to communicate some of the ideas that have come up in conversation and to generate a sense of ownership for the ideas behind the project.

The children and some parents that came along have been developing some ideas and words for the circular designs within the paths.

On the first May Bank Holiday weekend you may have seen us laying out the paths with flags designed by the children and their thoughts around what is important?

While talking about the designs and listening to the many individuals over the past few months I have been thinking about developing the idea of a conversation between people with the artworks. It would be possible to have the ideas and thoughts of an 8 year old and an 80 year old within the same circle ‘talking’ to each other.

I look forward to the next phase, developing the actual designs, looking at the materials to be used and finalising the overall path direction.

Les

## What is Important?

- Family
- Friends
- Pets
- Love
- Each other
- Homes
- No Vandalism
- Learning new things

